

Upper Hinge Adjustments

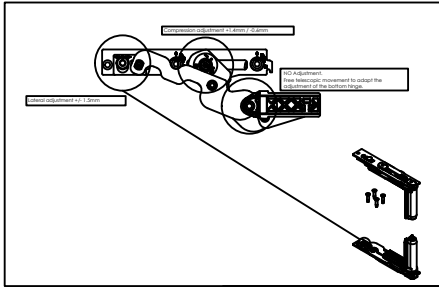

Bottom Hinge Adjustments

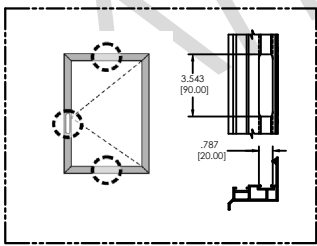
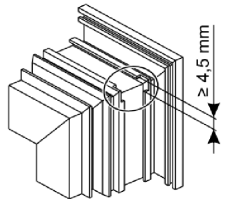
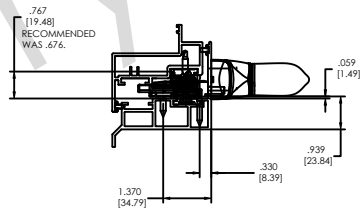
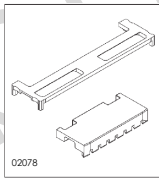
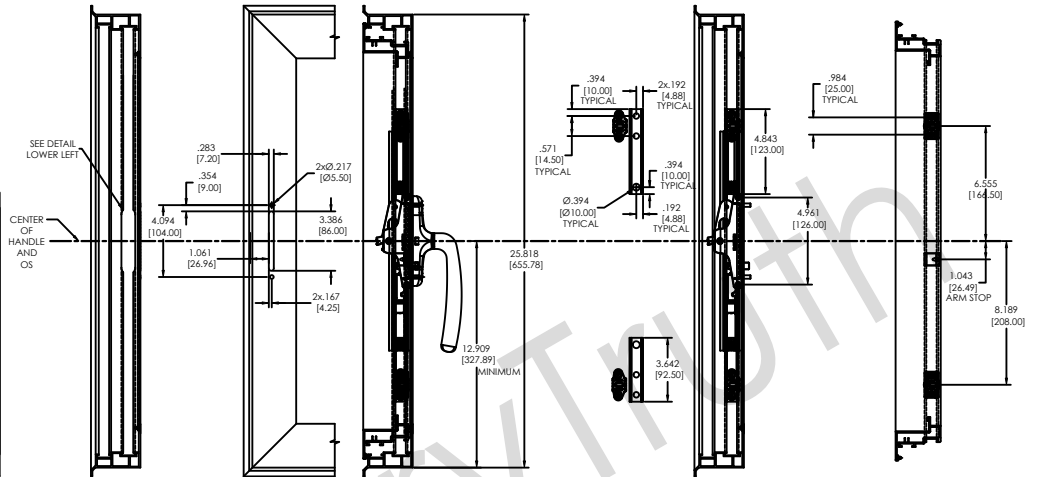
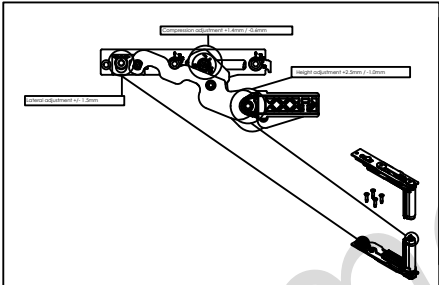

	Description	Part code	Length of mechanism arm	Length of micro-adjuster (inches)	Passes per lock	
A	Mechanism	OS Operator 2.0 basic mechanism	02008 000	317	12.480"	10
B	Arm	OS Operator arm - nylon slots - 172	02004 000	172	6.94"	10
		OS Operator arm - nylon slots - 150	02005 000	150	6"	10
		OS Operator arm - aluminum slots - 172	02004 000	172	6.94"	10
		OS Operator arm - aluminum slots - 150	02005 000	150	6"	10
C	Cremone	Ultron cremone	01171	120	4.7333"	10
		Ultron Key cremone	01172	120	4.7333"	10
		Long handle cremone	01128	172	6.7913"	10
		Away cremone (detachable handle)	01127	-	-	-
	Handle for Ultron Away cremone	01129	172	6.7913"	10	
D	Locking point (palet + keypad)	02007 000			10	
E	Connection rod	Rod out from bulk roll, for 15/20 groove	00254 596 N (black)	200 m	666.17 ft	1
		Rod out from bulk roll, for 15/20 groove	00254 542 N (grey)	200 m	666.17 ft	1
Other items	Gasket for Ultron cremone	00951 000			100	
	Set of wrenches for fixing OS Operator hardware	02003 000			20	

Note: for codes containing the characters "-", finish designation required.

TYPE	OS 2 CHIC HINGE APP
VERSION	OS 2 CHIC HINGE APP 2.00000
DATE	02/01/2018

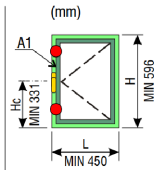
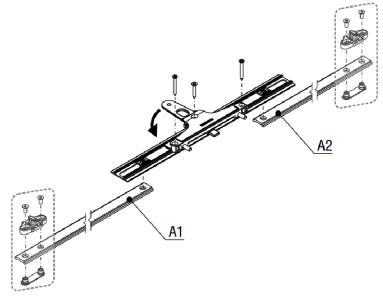

A1 = Hc - 146
A2 = H - Hc - 142